

SEAVIEW

ELEVATE YOUR ELECTRONICS

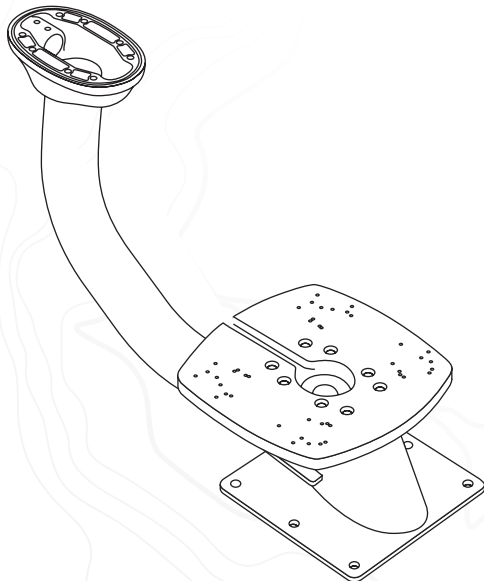

INSTALLATION INSTRUCTIONS

For Seaview Modular Dual Mount:

PMADM4M1

Refer to website for most up to
date instructions and videos.

WWW.SEAVIEWGLOBAL.COM

PARTS INCLUDED

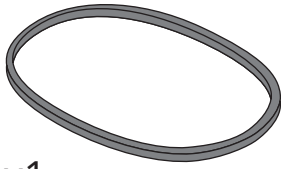

x1

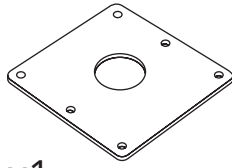

x1



x1

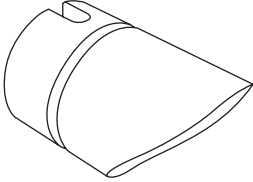

x1

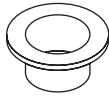

x6

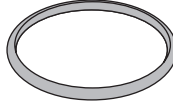

x1

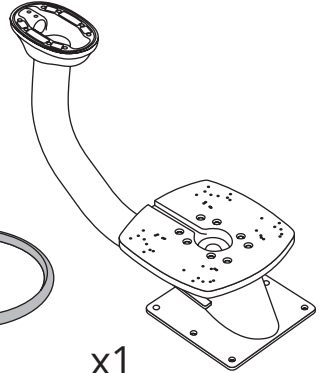

x1

TOOLS NEEDED

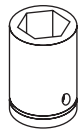
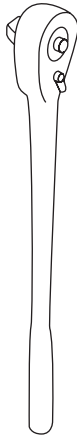

1/2" = 13mm

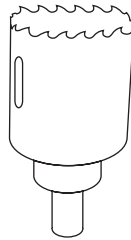

2" = 50mm

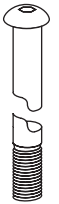
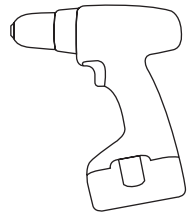

x6

Sudbury Elastomeric Marine Sealant is recommended. To purchase call 800-655-7922 or visit www.seaviewglobal.com

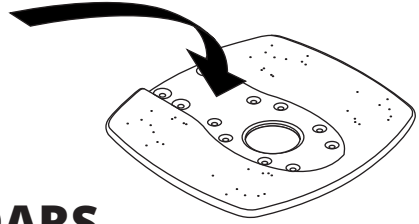
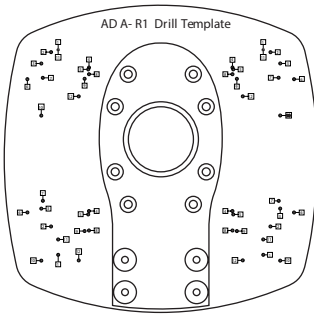

CLOSED DOME RADARS

Hole #	Manufacturer	Model
11	B&G	BR24, 3G, 4G
12	Furuno	15" - 24" radar domes
11	Garmin	18" - 24" and Fantom radar domes
8	Geonav	24" radar domes
4	JRC	15" radar domes
4	Koden	18" (MDC 900 Series) radar domes RB714A
		15" (MDC 900 Series) radar domes TB715A
10	Koden	25" radar domes, 715A, MDC 900 Series
8	Lorenz	12" - 24" radar domes
5	Lowrance	LR1800HD
11	Lowrance	BR24, 3G, 4G
10	Nobeltec	15" - 25" radar domes
3	Raymarine	18" - 24" radar domes
11	Raymarine	Quantum and Quantum 2 radar domes
8	Seiwa / Techmarine	12" - 24" radar domes
5	Simrad	18" radar domes (DX64S)
11	Simrad	BR24, 3G, 4G, HALO24
5	Sitex	18" (TZ760 / T921) radar domes
10	Sitex	25" radar domes

1 If you are using a Seaview Light Bar you do NOT use the pin.

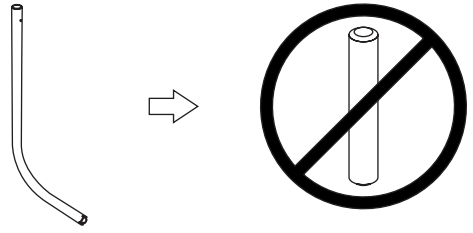

2 If you are not using a Seaview Light Bar then insert the pin as shown below. Insert the white Light Bar Plug and o-ring into the Light Bar hole in the back of the mount. Make sure it clips onto the pin.

Place the rubber gasket onto the top of the Dual Mount as shown.

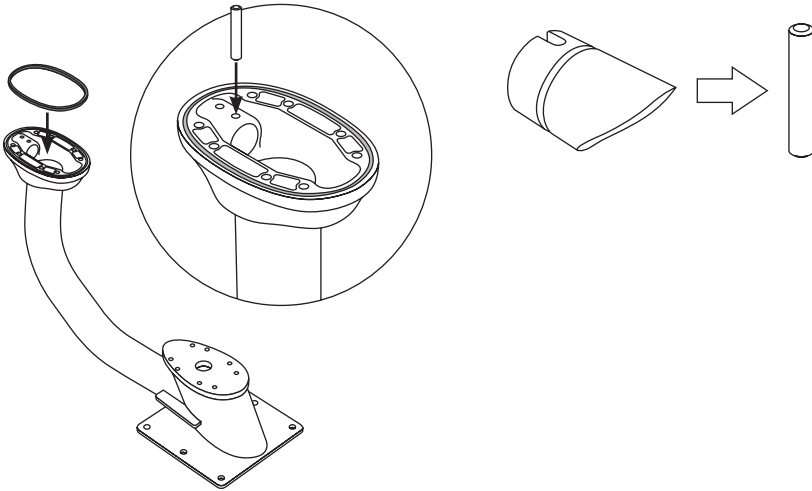

3 Mount the Seaview Modular Top Plate to the Dual Mount with the eight bolts that come with the Modular Top Plate.

Then insert the rubber cable grommet into the Modular Top Plate.

Refer to the provided Seaview Top Plate installation instructions for more information.

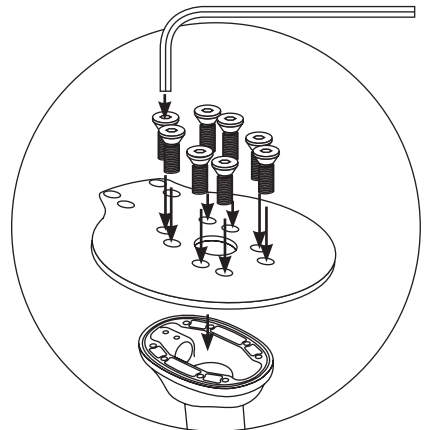

4 Place the PMADM4M1 onto the mounting surface.

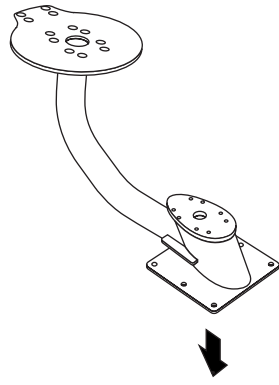

5 Mark the six base holes for drilling.

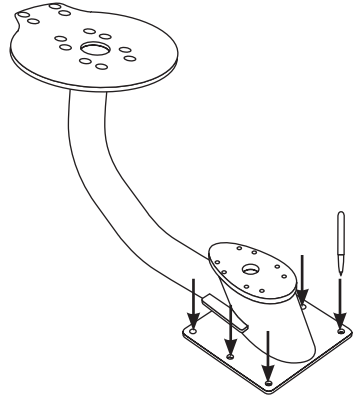

6 Remove the mount and rill the six bolt holes using a 3/8" drill bit.

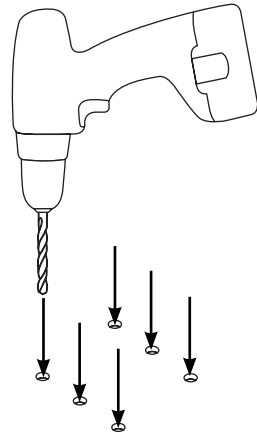

7 Using a hole saw, drill a hole for the cables.

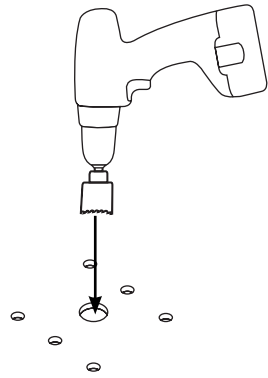

8 Place the ADA-R1 Drill Template on top of the Top Plate. Then mark the four holes for your specific closed dome radar.

Refer to page 2 of this instruction booklet to determine which holes to drill.

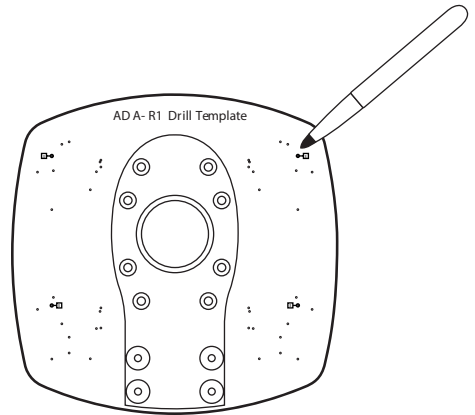

9 Drill the four holes you just marked.

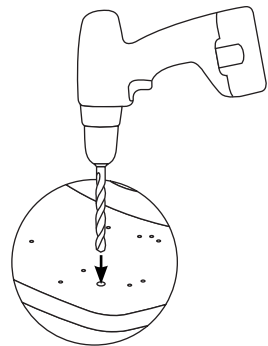

10

Apply marine adhesive sealant along the lip in the center hole on the Tope Plates. Route the cabling through the center hole in the Top Plates. Then insert through the black rubber grommet. When inserting the black rubber grommet into the Tope Plates be sure that the center lip falls into the groove in the grommet.

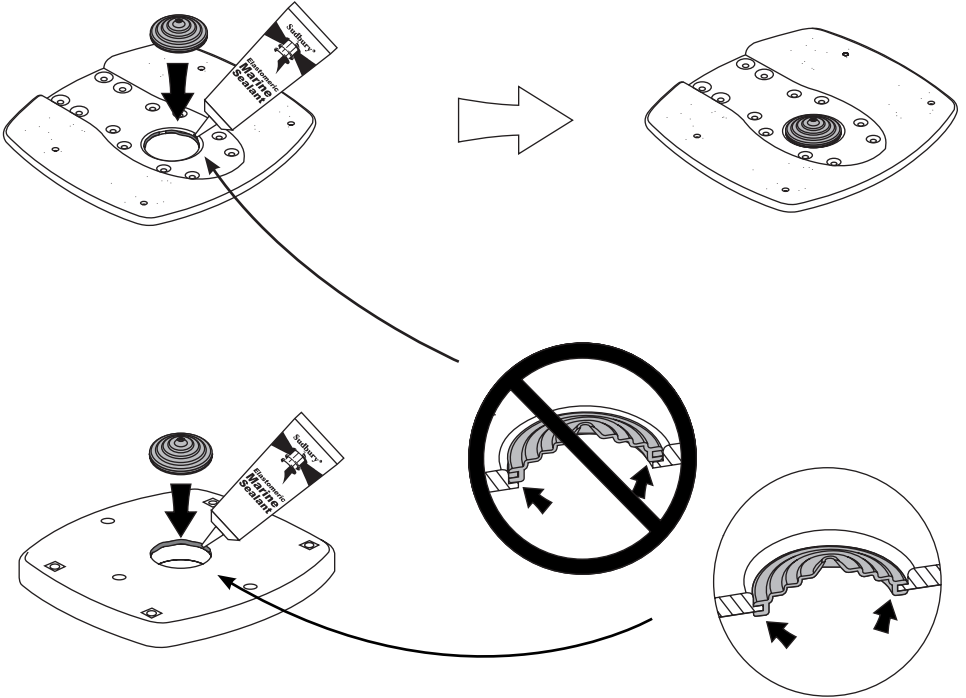

11

Apply marine adhesive sealant to the PMADM4M1 as shown.

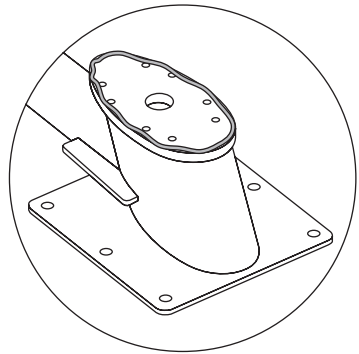

12

Place the radar Top Plate onto the PMADM4M1 making sure that the eight bolt holes line up.

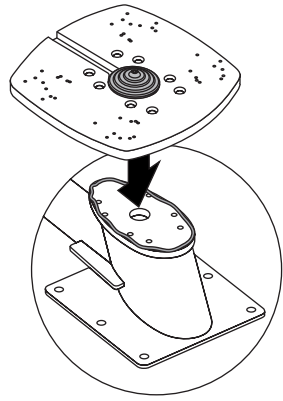

13

Secure the radar Top Plate to the PMADM4M1 with the eight bolts.

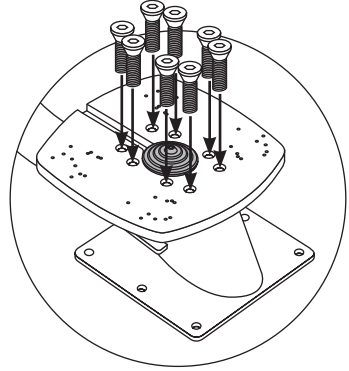

14

Apply marine adhesive sealant to the bottom of the mount.

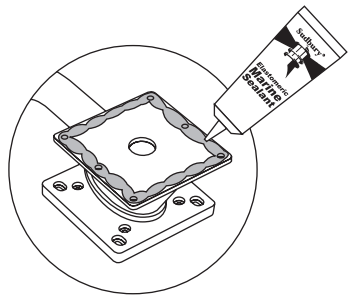

15 Route the cables through the mount.

TIP

Place the connector of the cable into a plastic bag. Apply Vaseline to the exterior of the plastic bag. Then try routing the connector/ cable through the black rubber grommet.

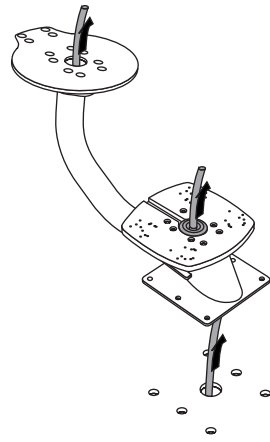

16 Lower the mount onto the mounting platform. Be sure to line up the mount with the six bolt holes you previously drilled.

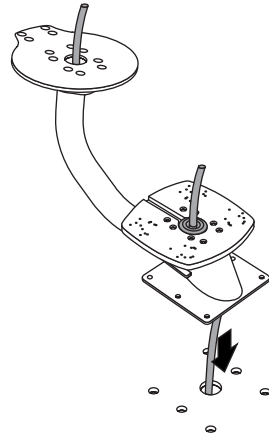

17 Apply marine adhesive sealant to the six nylon shoulder washers and insert them into the six bolt holes on the base.

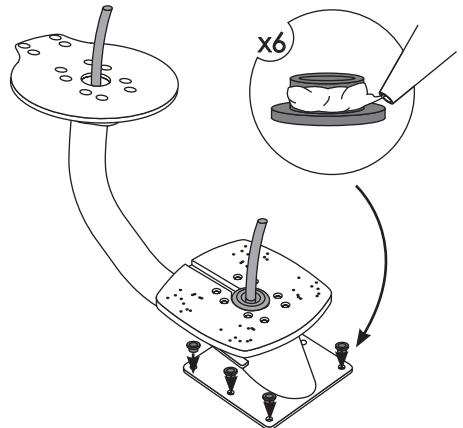

18

Use the provided backing plate. Apply marine adhesive sealant to all bolt holes.

Then secure with your own hardware.

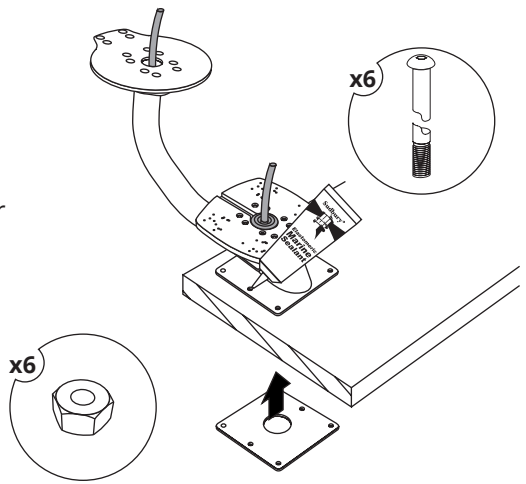

19

Mount and secure all electronics with your own mounting hardware.

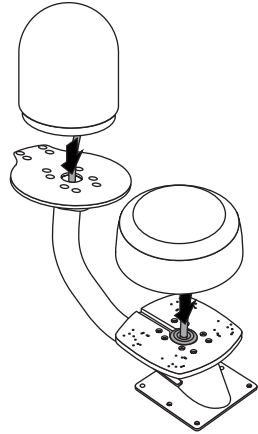

OPTIONAL ACCESSORIES

Call 800-655-7922 or visit www.seaviewglobal.com for available accessories.

LIGHT BARS

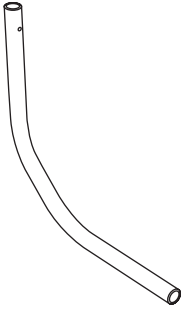

LTB-R

Fits closed dome radars.

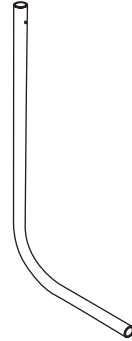

LTB-S

Fits 20" or smaller satdomes.

LIGHT BAR TOPS

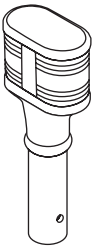

LTBP-1197

Perko Incandescent Light.

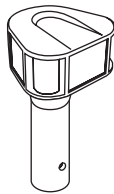

LTBA-7800

Attwood LED Light.

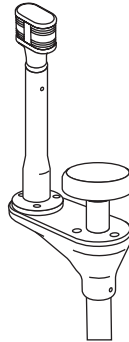

LTBU1A1197

Light Bar Top with Perko Incandescent Light, can fit GPS.

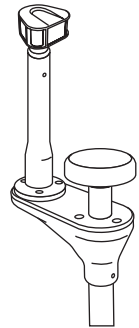

LTBU1A800

Light Bar Top with Attwood LED Light, can fit GPS.

SPREADER KIT

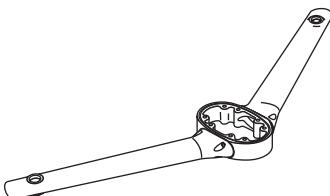

SP2-MOD

Allows user to mount GPS units or antennas on to a Seaview Modular Mount.

OPTIONAL ACCESSORIES

Call 800-655-7922 or visit www.seaviewglobal.com for available accessories.

CABLE GLANDS

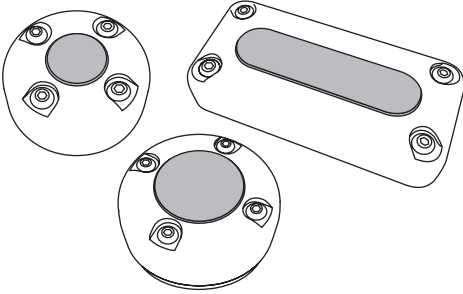

Seaview Cable Glands provide waterproof cable routing.

This page is intentionally left blank.

The background of the entire page is a light gray topographic map with white contour lines. The lines are irregular and wavy, representing elevation changes across a landscape. The map is centered and covers the entire area.

SEAVIEW///
ELEVATE YOUR ELECTRONICS

SEAVIEW///

Tel: 800-655-7922
www.seaviewglobal.com

EUROPEAN OFFICE

Tel: +33 4 94 53 27 70
www.seaviewprogress.com

1-010219